

Accessories ● Standard equipment UR016G ● Standard equipment UR017G

Plastic blade

| Cutting width | Plastic blade Set | Replacement plastic blade 12pcs. set |
|---------------|-------------------|--------------------------------------|
| 255mm | 198383-1 ●● | 198426-9 |

Shoulder strap assembly

For UR016G
Comfort
Part No.122A37-4 ●



Shoulder strap assembly

For UR017G
Single
Part No.122D94-0 ●



Brushcutter blade

| Blade dia | 2-tooth blade | 3-tooth blade | 4-tooth blade |
|-----------|---------------|---------------|--|
| 230mm | D-66058 | D-66020 | 195150-5 <i>Limited quantity</i> D-66008 |

Trimmer head

Part No. 197296-3
Cord/Line: 2.0mm
Ref.: 90-M10L



Part No. 198893-8
Cord/Line: 2.0mm
Ref.: 95-M10L



Part No. 191D89-4
Cord/Line: 2.0mm
Ref.: 96-M10L



Part No. 196324-1
Cord/Line: 2.4mm
Ref.: UN-74L/
100-M10L



Four-leaf spiral nylon cord

| green Size | Part No. | orange Size | Part No. |
|------------|----------|-------------|----------|
| 2.0mmx15m | 197471-1 | 2.4mmx15m | 198501-1 |
| 2.0mmx30m | 197472-9 | 2.4mmx30m | 198502-9 |
| 2.0mmx160m | 197473-7 | 2.4mmx120m | 198503-7 |
| 2.0mmx280m | 197474-5 | 2.4mmx180m | 198504-5 |

Protector U 330 set

Part No. 412969-0 ●●
(no packaging)



Part No. 1911X4-8
(package)

Charging Time

| | DC40RA | DC40RC |
|------------------|--------|--------|
| *1 BL4020 2.0Ah | 22 min | 30 min |
| *1 BL4025 2.5Ah | 28 min | 38 min |
| *1 BL4040 4.0Ah | 45 min | 67 min |
| *1 BL4050F 5.0Ah | 50 min | 85 min |

*1 Recommended battery

Items of standard equipment and specifications may vary by country or area.

The weight may differ depending on the attachment(s), including the battery cartridge. The lightest and heaviest combination, according to EPTA-Procedure 01/2014, are shown in the table.

Cordless Grass Trimmer UR016GZ / UR017GZ

| | | |
|--------------------------------|--|--|
| Brake | Cutting Width | Metal blade: 230 mm (9") Nylon Cutting Head: 330 mm (13") Plastic Blade: 255 mm (10") |
| Grass tangle removing function | No Load Speed (RPM) | High / Med. / Low: 6,500 / 5,300 / 3,500 |
| Electronic 3-Speed | Spindle size | M10 x 1.25 LH |
| Constant Speed | Sound Pressure Level / Sound Power Level | 2-Tooth Blade: 81.3 / 94.1 dB(A) Nylon Cutting Head: 82.2 / 92.3 dB(A) Plastic Blade: 81.8 / 90.5 dB(A) |
| Soft Start | Vibration level | Left / Right: 2.5 / 2.5 m/s ² or less |
| | Dimensions (L x W x H) | UR016G: 1,890 x 625 x 537 mm (74-1/2 x 24-5/8 x 21-1/8") UR017G: 1,890 x 362 x 265 mm (74-1/2 x 14-1/4 x 10-3/8") |
| | Net weight | UR016G: 4.7 - 5.3 kg (10.4 - 11.7 lbs.) UR017G: 4.2 - 4.8 kg (9.3 - 10.6 lbs.) |

UR016GZ/UR017GZ: Battery & charger not include

Standard Equipment: UR016GZ: Band assembly (122A37-4), plastic blade 255mm (198383-1), box driver (783013-3), hex wrench 4 (783202-0), accessory bag (831304-7), protector U 330 (412969-0).

UR017GZ: Band assembly (122D94-0), plastic blade 255mm (198383-1), box driver (783013-3), hex wrench 4 (783202-0), accessory bag (831304-7).

A3-032023-1



UR016G
Offset bike handle



UR017G
Loop handle



Lightweight design
Model: UR016G **5.3 kg**
with battery BL4050F
without Cutting tool and Shoulder strap



CÔNG TY TNHH MAKITA VIỆT NAM

| | | | |
|--|--|---|--|
| <p>CHI NHÁNH CTY TNHH MAKITA VN TẠI MIỀN BẮC</p> <p>Khu 5, Số 1, Đường Số 6, KCN - DT - DV VSP Bắc Ninh, P. Phú Châu, TP. Từ Sơn, T. Bắc Ninh.</p> <p>ĐT: 0222 376 5942 Fax: 0222 376 5941</p> | <p>TRUNG TÂM DỊCH VỤ KHÁCH HÀNG</p> <p>CHI NHÁNH ĐÀ NẴNG</p> <p>102 Triều Nữ Vương, P. Hải Châu 2, Q. Hải Châu, TP. Đà Nẵng.</p> <p>ĐT: 0236 352 5079 / 0236 352 5179 Fax: 0236 352 9478</p> | <p>TRUNG TÂM DỊCH VỤ KHÁCH HÀNG</p> <p>CHI NHÁNH BUỒN MA THUẬT</p> <p>88 Lê Đức Thọ, P. Thống Nhất, TP. Buôn Ma Thuột, T. Đắk Lắk.</p> <p>ĐT: 0262 355 4556 Fax: 0262 355 4557</p> | <p>TRUNG TÂM DỊCH VỤ KHÁCH HÀNG</p> <p>CHI NHÁNH NHÀ TRANG</p> <p>Lô 56-58 Đường B6, Khu đô thị Vinh Diễm Trưng, Xã Vinh Ngọc, TP. Nha Trang, T. Khánh Hòa.</p> <p>ĐT: 0259 220 0039</p> |
| <p>TRUNG TÂM DỊCH VỤ KHÁCH HÀNG</p> <p>CHI NHÁNH HÀ NỘI</p> <p>65 Trường Chinh, P. Phương Liệt, Q. Thanh Xuân, TP. Hà Nội.</p> <p>ĐT: 0243 202 2585</p> | <p>TRUNG TÂM DỊCH VỤ KHÁCH HÀNG</p> <p>CHI NHÁNH CẦN THƠ</p> <p>366 Võ Văn Kiệt, Khu Vực 5, P. An Thới, Q. Bình Thủy, TP. Cần Thơ.</p> <p>ĐT: 0292 389 4358 Fax: 0292 389 4359</p> | <p>TRUNG TÂM DỊCH VỤ KHÁCH HÀNG</p> <p>CHI NHÁNH HẢI PHÒNG</p> <p>Số 01 Lê Duẩn, Dã an Hoàng Hai Riverside, P. Thượng Lý, Q. Hồng Bàng, TP. Hải Phòng.</p> <p>ĐT: 0225 883 1529</p> | <p>TRUNG TÂM DỊCH VỤ KHÁCH HÀNG</p> <p>CHI NHÁNH HỒ CHÍ MINH</p> <p>Số 12 Trịnh Văn Cấn, P. Cầu Ông Lãnh, Q. 1, TP. Hồ Chí Minh.</p> <p>ĐT: 0283 821 5161</p> |



Multi functional control panel: near right hand position for easy access and operation

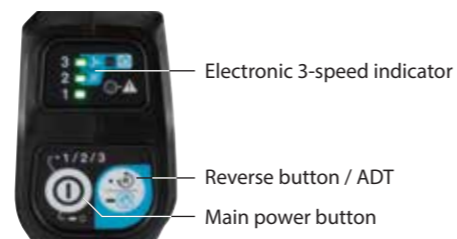

Operation mode can be selected to suit the type of blade.



Run Time with Plastic blade and BL4040

High Med Low
260 / 135 / 90 min

on a single full battery charge/ No load

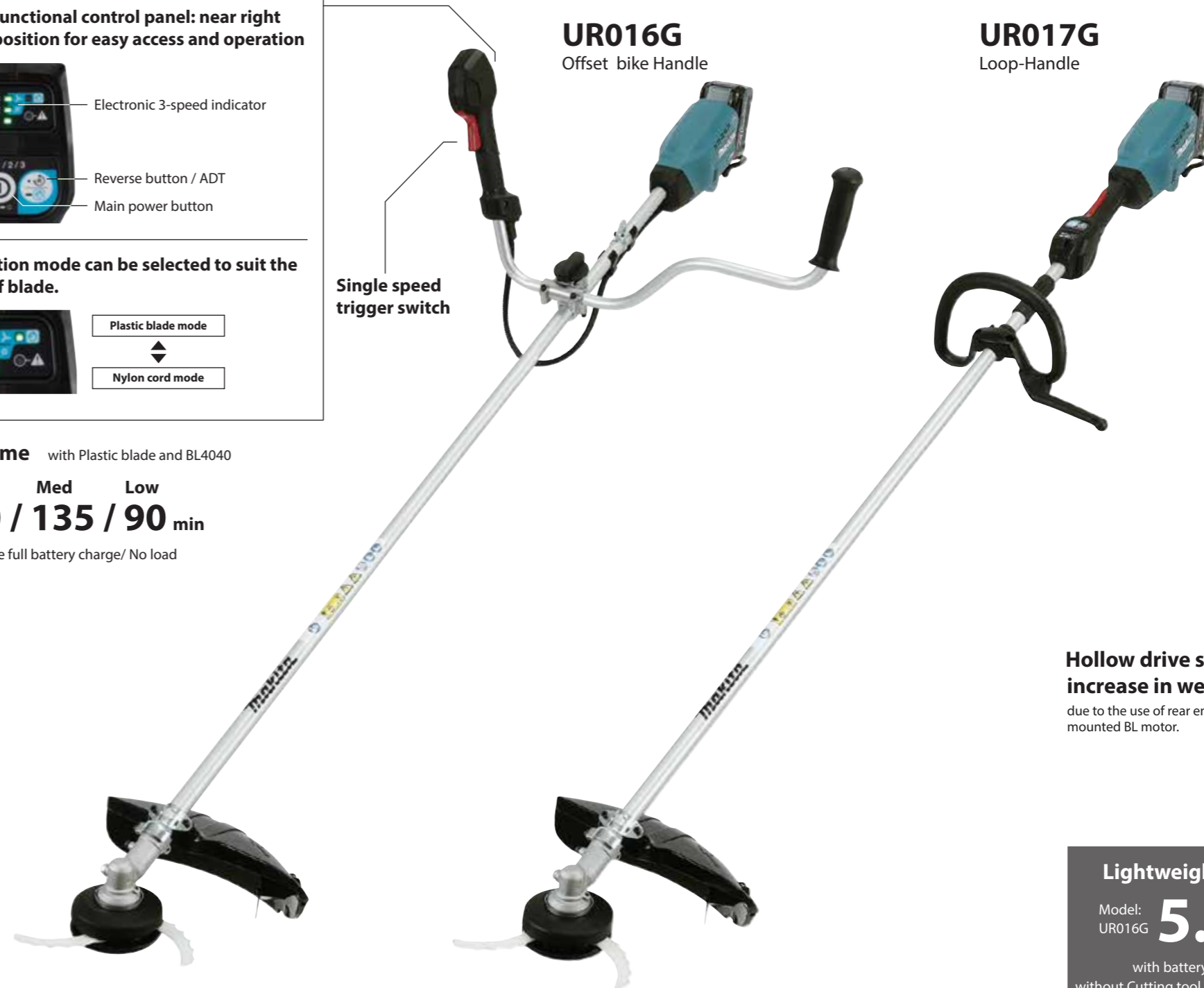

Hollow drive shaft minimizes increase in weight

due to the use of rear end mounted BL motor.



Lightweight design

Model: UR016G **5.3 kg**

with battery BL4050F without Cutting tool and Shoulder strap

BL MOTOR

Rear end mounted BL motor

makes the tool weight balance similar to engine grass trimmers



ADT

Automatic torque Drive Technology

Automatically changes the cutting speed according to grass density.

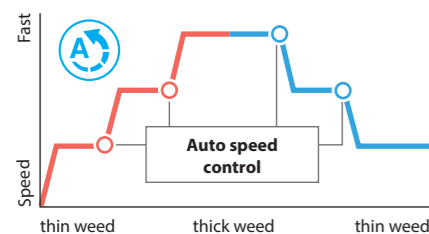

AFT

Active Feedback sensing Technology

Torque limiter turns the motor off if the tool is suddenly forced to lock

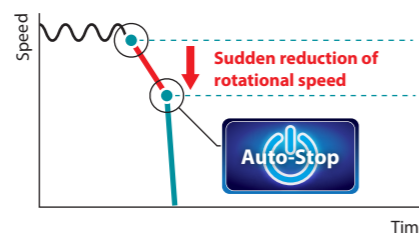

XPT

eXtreme Protection Technology

Enhanced Dust and Drip-proof Performance ensure reliable operation even under bad weather

IPX4-compatible



Grass tangle removing function

Reverse switch for clearing entangled weeds and grass from cutting head



Toolless handle lock mechanism for good portability

