

**High Power
Durability
Digital Communication**

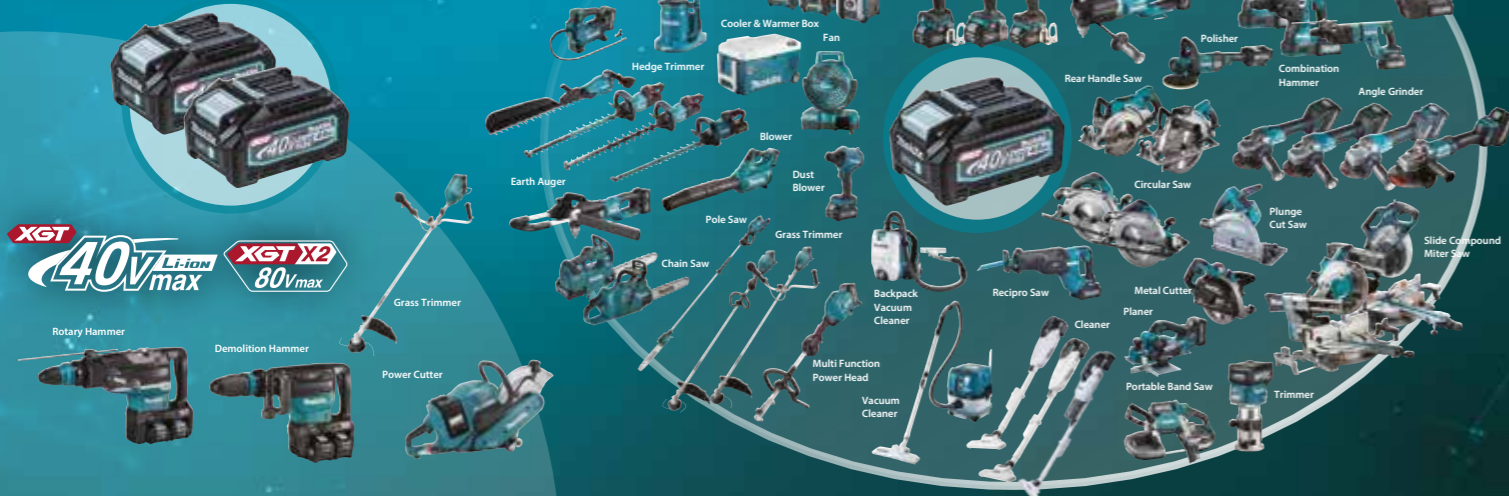

Cordless Vacuum Cleaner
VC001GL / VC003GL Wet & Dry
VC002GL / VC004GL Airborne particles
VC005GL Dry (for building maintenance industry)

Accessories

Filter for water set

Model: VC001GL, VC003GL
Part No. 191V67-2



Damper set

Model: VC002GL, VC004GL
Part No. 191V68-0



Pre filter set

Model: VC002GL, VC004GL
Part No. 191V69-8



Powder filter H set

Model: VC002GL, VC004GL
Part No. 191V70-3



Cloth filter set

Model: VC001GL, VC003GL,
VC002GL, VC004GL
Part No. 144625-1



Model: VC005GL
Part No. 191V71-1

Poly bag set (10pcs)

Part No. 195432-5



Filter bag set 15L (5pcs)

Part No. 195557-5



MAKPAC adapter set

Part No. 198730-6 / 198599-8 (EU)



Charging Time

| 40V Li-ion max | Fast Charging | |
|-----------------|---------------|---------|
| | DC40RA | DC40RC |
| BL4020 2.0Ah | 22 min | 30 min |
| BL4025 2.5Ah | 28 min | 38 min |
| *1BL4040 4.0Ah | 45 min | 67 min |
| *1BL4050F 5.0Ah | 50 min | 85 min |
| *1BL4080F 8.0Ah | 76 min | 170 min |

*1 Recommended battery

Cordless Vacuum Cleaner VC001GL / VC002GL / VC003GL / VC004GL / VC005GL

| | VC001GL | VC002GL | VC003GL | VC004GL | VC005GL |
|------------------|--|--|--|--|--|
| Variable Speed | Capacity: Dust / Water: 8 / 6 L | Dust: 8 L | Dust / Water: 15 / 12 L | Dust: 15 L | Dust: 8 L |
| Revolving Hose | Max Air Flow: 3.2 m ³ /min | 1.8 m ³ /min | 3.2 m ³ /min | 1.8 m ³ /min | 2.8 m ³ /min |
| Static Free Hose | Max Sealed Suction: 23 kPa | 23 kPa | 23 kPa | 23 kPa | 23 kPa |
| | Continuous Use (min.): w/ BL4050F at Dial 1 / 5: 220 / 28 | w/ BL4050F at Dial 1 / 5: 220 / 28 | w/ BL4050F at Dial 1 / 5: 220 / 28 | w/ BL4050F at Dial 1 / 5: 220 / 28 | w/ BL4050F at Dial 1 / 5: 220 / 28 |
| | Vibration Level: 2.5 m/s ² or less | 2.5 m/s ² or less | 2.5 m/s ² or less | 2.5 m/s ² or less | 2.5 m/s ² or less |
| | Sound Pressure Level: 70 dB(A) or less | 70 dB(A) or less | 70 dB(A) or less | 70 dB(A) or less | 70 dB(A) or less |
| | Dimensions (L x W x H): 366 x 334 x 425 mm (14-3/8 x 13-1/8 x 16-3/4") | 366 x 334 x 425 mm (14-3/8 x 13-1/8 x 16-3/4") | 366 x 334 x 475 mm (14-3/8 x 13-1/8 x 18-3/4") | 366 x 334 x 475 mm (14-3/8 x 13-1/8 x 18-3/4") | 366 x 334 x 397 mm (14-3/8 x 13-1/8 x 15-5/8") |
| | Net weight: 8.1 - 11.2 kg (17.9 - 24.7 lbs.) | 8.3 - 11.4 kg (18.3 - 25.1 lbs.) | 8.4 - 11.5 kg (18.5 - 25.4 lbs.) | 8.6 - 11.7 kg (19.0 - 25.8 lbs.) | 7.9 - 11.0 kg (17.4 - 24.3 lbs.) |

Standard Equipment : ALL: Floor Nozzle, Straight Pipe, Bent Pipe, Hose, Plastic Dust Bag, Stopper, Multi Hook, Battery, Charger

VC001GL / VC003GL: Plastic Dust Bag x10, Telescopic pipe assembly, Long Sash Nozzle

VC002GL / VC004GL: Plastic Dust Bag x10, Front Cuff (country-specific)

VC005GL: Paper Dust Bag, Telescopic pipe assembly, Long Sash Nozzle

The weight does not include accessories but battery cartridge(s). The lightest and heaviest combination weight of the appliance and battery cartridge(s) are shown in the table.

Items of standard equipment and specifications may vary by country or area.

Makita Corporation

3-11-8 Sumiyoshi-cho, Anjo, Aichi, 446-8502 Japan

PRINTED IN JAPAN 202201



photo: VC003GL

photo: VC002GL

Low noise
46 dB(A)
Dial mode: 1
Model: VC001GL

For Cleaning

Wet & Dry

BL XPT

VC001GL
8L



VC003GL
15L



For Dust Collecting

Airborne particles

HEPA filter **BL XPT** **AWS** **GAFFLU** **XPT**

VC002GL
8L



VC004GL
15L



For Cleaning

Dry (for building maintenance industry)

BL XPT

VC005GL
8L



Excellent Vacuum performance equivalent to Corded models achieved by improving cooling efficiency against more heat generation from electrical parts due to the increased output power.



photo: VC003GL



photo: VC004GL



photo: VC005GL

Powered by 40Vmax XGT Li-Ion battery (two in parallel)

photo: VC001GL



Continuous use
Battery: BL4050F x2

220min
Dial mode: 1

28min
Dial mode: 5



Automatically switches to the second battery when the first battery runs out.

For Cleaning

Wet & Dry



VC001GL
8L

VC003GL
15L



For Dust Collecting

Airborne particles



VC002GL
8L

VC004GL
15L



For Cleaning

Dry (for building maintenance industry)

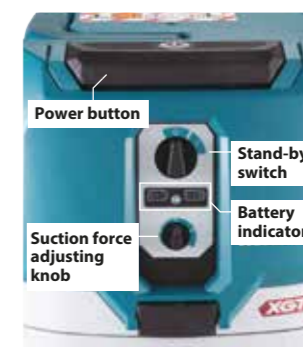

VC005GL
8L



Telescopic pipe with lock
VC001GL / VC003GL / VC005GL
(country-specific)

- A locking mechanism has been added to the connection of bending pipe and this pipe to prevent from falling off.
- Available in lightweight plastic and rigid aluminum



The lower profile makes it easier to clean under furnitures.
VC001GL / VC003GL / VC005GL
(country-specific)

48 mm



Mode switching lever
VC001GL / VC003GL / VC005GL
(country-specific)
Hard floor/carpet mode switchable

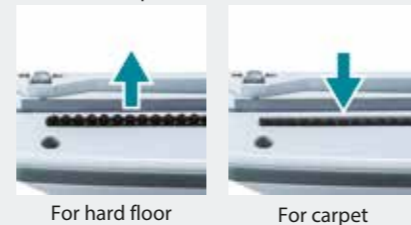

AWS Auto-start Wireless System
VC002GL / VC004GL

The wireless activation function enables clean and comfortable operation. By connecting a supported tool to the cleaner, you can run the cleaner automatically along with the switch operation of the tool.



New 8L tank VC005GL

- Compact tank reduces the overall height of the cleaner.
- Rear wheels attached to the tank have been increased in size to reduce the risk of the machine from tipping over and to enhance the stability of straight running.

Rear wheel size
ø 120 mm

