



Cordless Rotary Hammer HR005G 40 mm (1-9/16") Adapted for SDS-Max bits

High Power
Durability
Digital Communication



40V Li-ion max

Impact energy
[EPTA-Procedure 05/2009]
8.0 Joule

Portable Power Pack

PDC01

Powered by up to four 18V LXT batteries



PDC1200

Equipped with built-in battery cells

Charger: DC4001

Charging time: 6hours



Adapter set (40Vmax)

Part No. 191N62-4



Accessories

Dust Extractor Attachment Set

Drilling / Hammering

Part No. 199142-6

Drilling mode

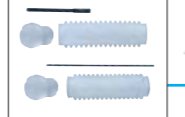

Hammering mode



Hammering

without Vacuum hose set

Part No. 199143-4

with Vacuum hose set

Part No. 199144-2

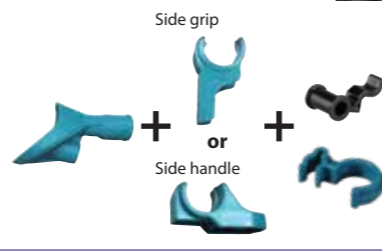

Cordless Rotary Hammer

HR005G 40 mm (1-9/16") Adapted for SDS-Max bits

Variable Speed	Impact Energy	EPTA-Procedure 05/2009: 8 J
Brake	Capacity	Concrete (w/ TCT Bit): 40 mm (1-9/16")
SDS-MAX Shank	Blows Per Minute (BPM)	1,450 - 2,900
Torque Limiter	No Load Speed (RPM)	250 - 500
Constant Speed	Sound Pressure Level	91 dB(A)
Soft Start	Sound Power Level	102 dB(A)
Dust Collection	Vibration Level	Hammer Drilling into Concrete: 5.0 m/s ² Chiselling Function w/ Side Grip: 4.0 m/s ² Chiselling Function w/ Side Handle: 4.0 m/s ²
Built-in Job Light	Dimensions (L x W x H)	w/o Battery: 477 x 115 x 286 mm (18-3/4 x 4-1/2 x 11-1/4") w/ BL4040: 500 x 115 x 286 mm (19-3/4 x 4-1/2 x 11-1/4") w/ BL4050F: 520 x 115 x 305 mm (20-1/2 x 4-1/2 x 12")
Carrying Case	Net weight	7.4 - 8.2 kg (17.0 - 18.1 lbs.)
	Standard Equipment	Side Handle, Side Grip, Depth Gauge, Bit Grease, Cloth, Wireless Unit (country-specific), Wireless Unit Adapter (country-specific), Battery, Charger

The weight may differ depending on the attachment(s), including the battery cartridge. The lightest and heaviest combination, according to EPTA-Procedure 01/2014, are shown in the table. Items of standard equipment and specifications may vary by country or area.

As powerful as AC tools

Net weight

7.7 kg

with BL4040



Makita Corporation

3-11-8 Sumiyoshi-cho, Anjo, Aichi, 446-8502 Japan

PRINTED IN JAPAN 202012



Impact energy
[EPTA-Procedure 05/2009]
8.0
Joule

diameter 32mm (1-1/4") / Drilled holes to a depth of 140 mm / Concrete with compressive strength of 40N/mm²

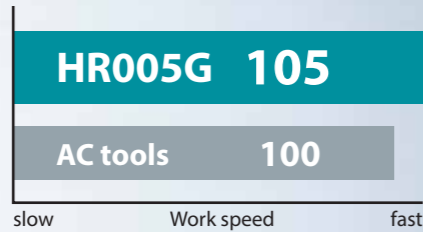

Anti-Vibration Technology

AVT Vibration level at main handle
5.0 m/s²

Active dynamic vibration absorber moves in the opposite direction to the drive piston to reduce vibration.



SOFT NO LOAD



2 mode
Rotation + Hammering ◀ ▶

AFT Active Feedback sensing Technology

turns the motor off if bit rotation is suddenly forced to stop.

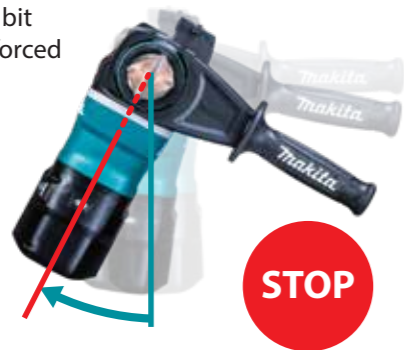

AWS Auto-start Wireless System

connects to compatible vacuum cleaner with Bluetooth. The vacuum cleaner automatically runs while the switch is on.

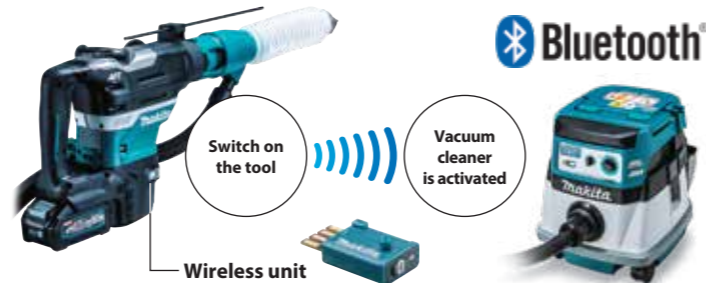

XPT eXtreme Protection Technology

