



# Cordless Vacuum Cleaner Series



DVC155L / DVC156L / DVC157L **15L**

DVC865L / DVC866L / DVC867L **8L**

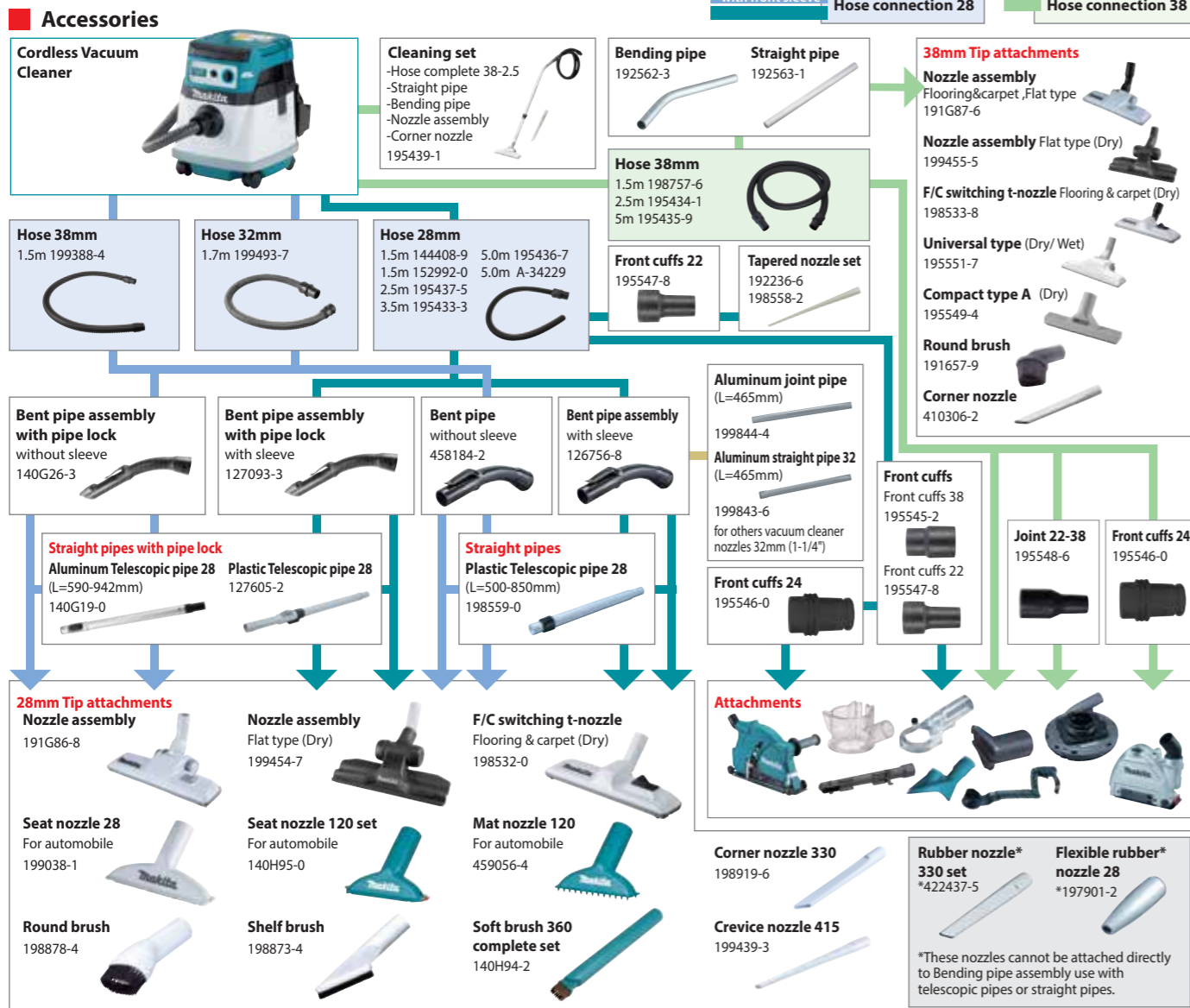

## Cordless Vacuum Cleaner

DVC155L / DVC156L / DVC157L / DVC865L / DVC866L / DVC867L

	DVC155L / DVC156L / DVC157L	DVC865L / DVC866L / DVC867L
Variable Speed		
Revolving Hose		
Static Free Hose		
<b>Capacity</b>	DVC155L: Dust / Water: 15 / 12 L DVC156L / DVC157L: Dust: 15 L	DVC865L: Dust / Water: 8 / 6 L DVC866L / DVC867L: Dust: 8 L
<b>Continuous Use (min.)</b>	w/ BL1860B: 100	w/ BL1860B: 100
<b>Max Air Flow</b>	DVC155L / DVC156L: 2.1 m³/min, DVC157L: 2.4 m³/min	DVC865L / DVC866L: 2.1 m³/min, DVC867L: 2.4 m³/min
<b>Max Sealed Suction</b>	11 kPa	11 kPa
<b>Suction Power</b>	DVC155L / DVC156L: 105 W / DVC157L: 110 W	DVC865L / DVC866L: 105 W / DVC867L: 110 W
<b>Vibration Level</b>	2.5 m/s² or less	2.5 m/s² or less
<b>Sound Pressure Level</b>	70 dB(A) or less	70 dB(A) or less
<b>Dimensions (L x W x H)</b>	366x334x421 mm (14-3/8"x13-1/8"x16-1/2")	366x334x368 mm (14-3/8"x13-1/8"x14-1/2")
<b>Net weight</b>	DVC155L: 7.2 - 7.9 kg (15.9 - 17.4 lbs.) / DVC156L: 7.3 - 7.9 kg (16.1 - 17.4 lbs.) / DVC157L: 8.0 - 8.6 kg (17.6 - 19.0 lbs.)	DVC865L / DVC866L: 7.0 - 7.7 kg (15.4 - 17.0 lbs.) / DVC867L: 7.7 - 8.4 kg (17.0 - 18.5 lbs.)

**Standard Equipment:** Plastic Dust Bag x10, Tool Box, Battery, Charger, Wireless Unit (DVC157L/DVC867L)  
**Country-specific:** Hose Complete, Telescopic Pipe Assembly, Bent Pipe, Pipe, Long Sash Nozzle, Nozzle Assembly, Corner Nozzle, Front Cuffs (22, 24, 38)

The weight does not include accessories but battery cartridge(s). The lightest and heaviest combination weight of the appliance and battery cartridge(s) are shown in the table.  
 Items of standard equipment and specifications may vary by country or area.

**Makita Corporation**  
 3-11-8 Sumiyoshi-cho, Anjo, Aichi, 446-8502 Japan  
 PRINTED IN JAPAN 202005



18v + 18v → 36v

# High power & Low noise



**Max sealed suction**  
**11 kPa**  
 Dial mode: 5

**Low noise**  
**55 dB**  
 Dial mode: 1



# Makita low noise vacuum cleaner series

Max sealed suction

**11 kPa**

Dial mode: 5

Low noise

**55 dB**

Dial mode: 1

## Telescopic pipe with lock

- A locking mechanism has been added to the connection of bending pipe and this pipe to prevent from falling off.
- Available in lightweight plastic and rigid aluminum

## Telescoping button

slide button style

## Mode switching lever

For hard floor For carpet



**48mm**



## Increased suction power

achieved by redesigned motor

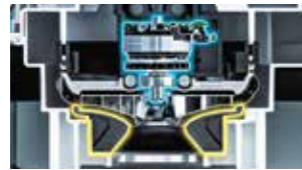

Large on-off switch allows for easy on/off switching

Dual battery fuel gauge



Main power switch

Variable suction power control by dial  
Suction power is variably adjustable to suit application.

## BL MOTOR Brushless motor

New cloth filter for dry use designed for the building maintenance industry  
DVC156L / DVC866 only  
Features a simple structure assuming use of paper dust bag.



Paper dust bag Cloth filter set



**Low noise**  
Disturbing noises like wind noise have been reduced by redesigning air vents and air paths.



**Designed to run stably**  
A support leg with two rollers has been added to tool box. When you run the cleaner by pulling the hose, the rollers prevent it from tipping over backward.



Continuous use  
**100 / 40 min**

Dial mode: 1 / 5  
Battery: BL1860B x 2  
ø32 x 1.7m hose

## For Cleaning

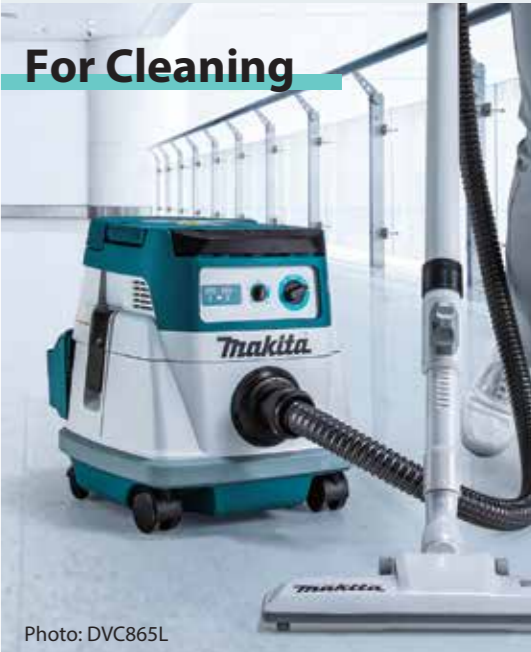

Photo: DVC865L

## For Dust Collecting

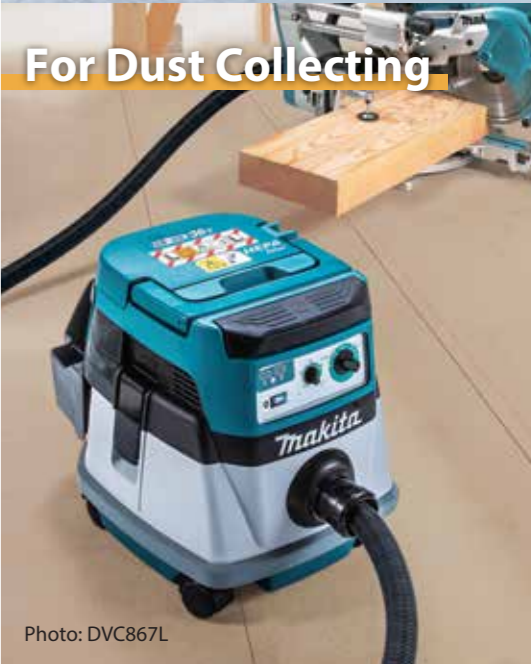

Photo: DVC867L

## For Cleaning

### Wet & Dry



DVC155L

Tank capacity  
**15L**



DVC865L

Tank capacity  
**8L**

### Dry only



DVC156L

Tank capacity  
**15L**



DVC866L

Tank capacity  
**8L**

## For Dust Collecting

### Dry only



DVC157L

Tank capacity  
**15L**



DVC867L

Tank capacity  
**8L**



## Auto-start Wireless System DVC157L / DVC867L only

The wireless activation function enables clean and comfortable operation. By connecting a supported tool to the cleaner, you can run the cleaner automatically along with the switch operation of the tool.



**AWS connects to power tool with Bluetooth**  
The Bluetooth® word mark and logos are registered trademarks owned by the Bluetooth SIG, Inc. and any use of such marks by Makita is under license. Other trademarks and trade names are those of their respective owners.