

XGT is a new system with its own tools, batteries, and chargers. A combination of innovative tool design and higher output batteries provide a genuine solution for high demand industrial users.

Optimum power supply system and Optimum charging system

The XGT range of tools and batteries come with a built-in program, providing digital communication between the battery and tool. Allowing not only for the battery to talk with tool but also the tool to talk to the battery. Battery technology and motor engineering that work together for optimum performance.

Tool ↔ Battery ↔ Battery Charger
Digital communication

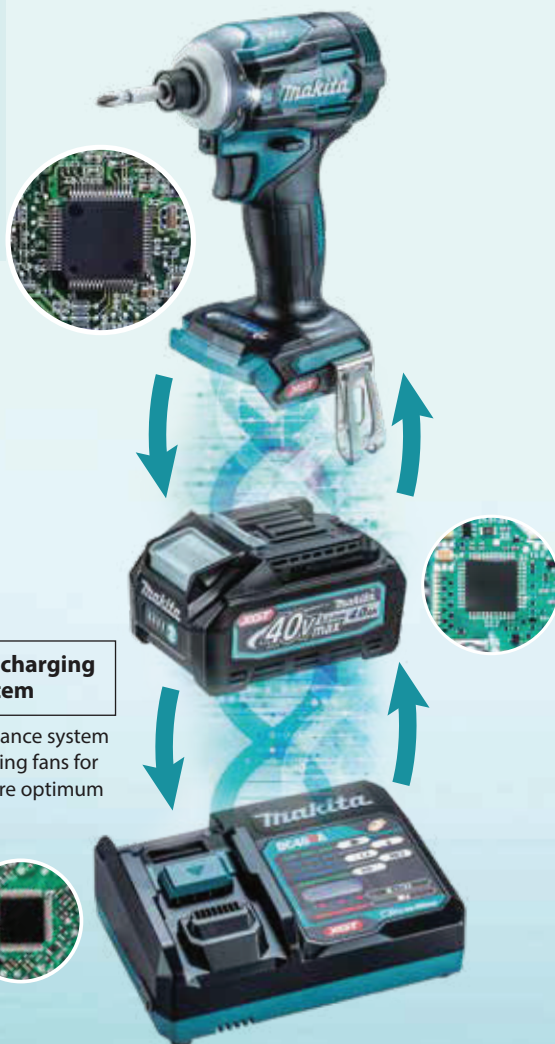

Optimum charging system

Auto maintenance system with two cooling fans for providing more optimum fast charging

Built Tough

High durability specifications specially designed for 40Vmax Li-Ion batteries

4-LED fuel gauge indicator

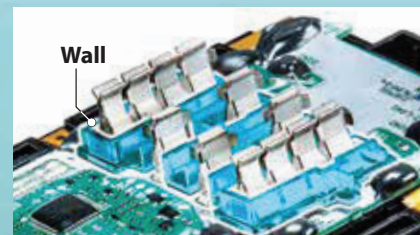
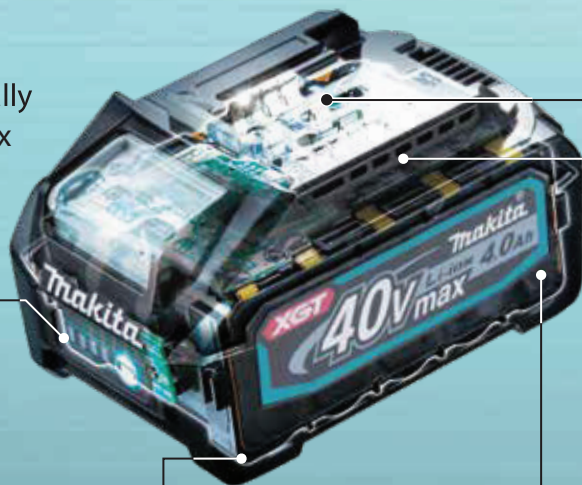

Terminal short-circuit prevention structure
The protection wall is provided between terminals against water and dust.

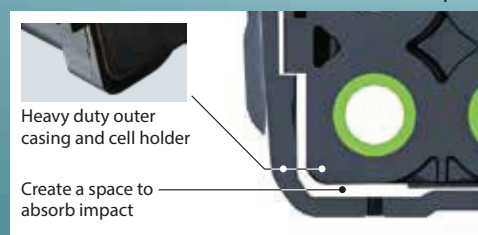

Shock absorption structure

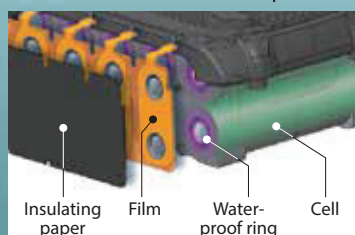

Waterproof Triple-layer Structure
prevents cell failure due to water and dust.

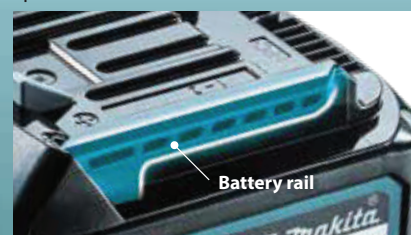

High Rigidity Battery Rails
Durable slide in battery rail that holds the battery and the tools firmly and securely to withstand high power products

Rapid Optimum Charging System

It is necessary to cool down before start charging when the battery temperature is high.

Built-in fan circulates air through the battery before start charging and during the charging process to cool the battery for faster charge time.

The optimum charging system

Forced air cooling



Fast charging



General charging method

Natural heat dissipation



Waiting time for charging



The Makita Rapid Optimum Charger communicates with the battery's built-in chip throughout the charging process to optimize battery life by actively controlling current, voltage and temperature.



The optimum charging system

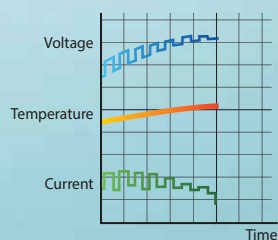

General charging method

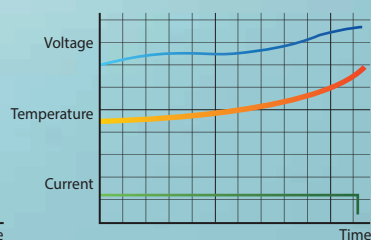

Battery Protection Function

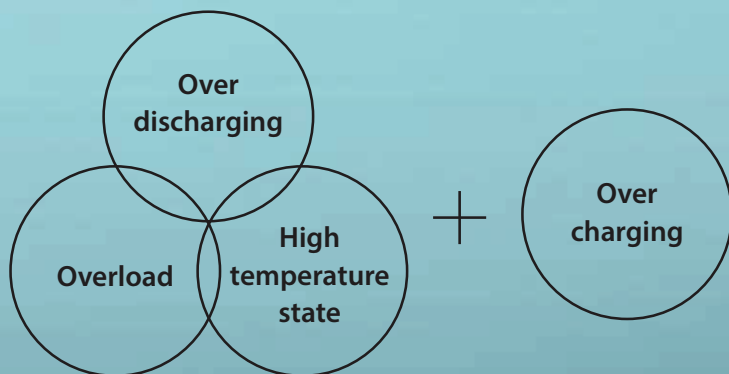

This function is communication technology that allows the tool and battery to monitor conditions and exchange data in real time to protect against Overload, Over-Discharge and Overheating.

Anytime Charge

No Memory Effect
No discharging required



Shock Absorbing

Heavy Duty Pack

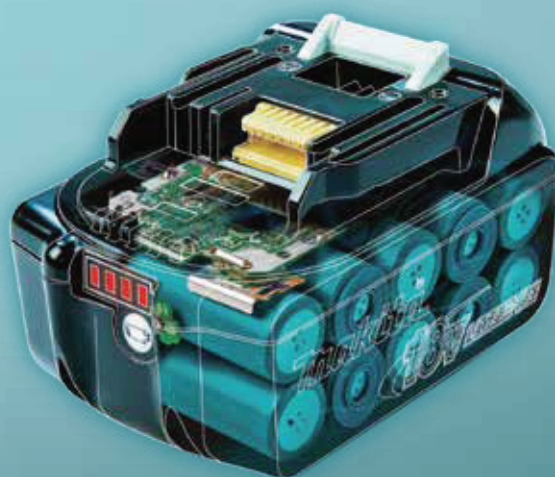

Firm Holding

Multi-contact terminals reduce electrical resistance and increase connection stability withstanding against vibration, and ultimately ensures Stable current supply to the tool.

