



**Combination Hammer**  
HR001G / HR002G / HR003G / HR004G  
28 mm (1-1/8")

**AVT** Anti Vibration Technology

Vibration Level  
**7.0 m/s<sup>2</sup>**



**AFT** Active Feedback sensing Technology

turns the motor off if bit rotation is suddenly forced to stop.  
(HR001G / HR002G)

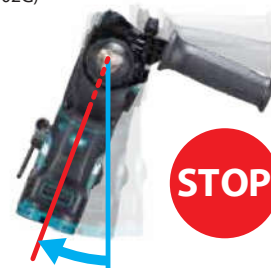

**Redesigned Tool Balance for Increased Operability**

The tool's center of gravity is located as close to the handle grip as possible, providing more control and less fatigue.

<b>Lightweight</b>
<b>3.9 kg</b>
Model: HR001G Battery: BL4025



**AWS** Auto-start Wireless System

connects to compatible vacuum cleaner with Bluetooth. The vacuum cleaner automatically runs while the switch is on.  
(HR001G / HR002G)

Bluetooth

Switch on the tool

Vacuum cleaner is activated





Work amount on a full battery charge\*  
Battery: BL4025

about **120 pcs**  
Drilled holes a depth of 60mm (2-3/8") with ø12.5mm bit

**BL MOTOR** **AFT** **AWS** **AVT** **SOFT NOLOAD** **XPT**  
HR001G / HR002G HR001G / HR002G HR001G / HR002G



Large dust box cover can be opened simply by pushing single push button for easy dust cleaning.



Quick change drill chuck (HR002G / HR004G)

Dust Extraction System

DX12 / DX14



	Quick change drill chuck	AFT	AWS	Dust Extraction System
HR001G	—	✓	✓	DX12
HR002G	✓	✓	✓	DX14
HR003G	—	—	—	DX12
HR004G	✓	—	—	DX14

	HR001G / HR003G	HR002G / HR004G
Impact Energy	EPTA-Procedure 05/2009: 2.8 J	EPTA-Procedure 05/2009: 2.9 J
Capacity	Concrete / Steel / Wood / Core Bit / Diamond Core Bit (Dry Type): 28 / 13 / 32 / 54 / 65 mm	Concrete / Steel / Wood / Core Bit / Diamond Core Bit (Dry Type): 28 / 13 / 32 / 54 / 65 mm
Blows Per Minute (BPM)	(1-1/8" / 1/2" / 1-1/4" / 2-1/8" / 2-9/16")	(1-1/8" / 1/2" / 1-1/4" / 2-1/8" / 2-9/16")
No Load Speed (RPM)	0 - 5,000	0 - 5,000
Chuck Capacity	0 - 980	0 - 980
Sound Pressure Level	1.5 - 13 mm (1/16 - 1/2")	1.5 - 13 mm (1/16 - 1/2")
Sound Power Level	95 dB(A)	93 dB(A)
Dimensions (L x W x H)	106 dB(A)	104 dB(A)
	w/ BL4025: 358x102x232 mm (14-1/8"x4"x9-1/8")	w/ BL4025: 389x102x232 mm (15-1/4"x4"x9-1/8")
	w/ BL4040: 373x102x238 mm (14-3/4"x4"x9-3/8")	w/ BL4040: 404x102x238 mm (15-7/8"x4"x9-3/8")
Net weight	3.9 - 4.6 kg (8.6 - 10.1 lbs.)	HR002G: 4.1 - 4.6 kg (9.0 - 10.1 lbs.) HR004G: 4.0 - 4.5 kg (8.8 - 9.9 lbs.)

\*1 The test results depend to a great extent on the test material etc. 15